



**BAUSCHER**  
GERMANY

HOTEL BUSINESS AND GASTRONOMY



# dialog

## Clean lines

The *Dialog* collection for universal use ensures a stylish atmosphere for every table setting. The design of the pieces and the fine relief lines combine to make a timeless design statement. Together with the extensive range of items and essential features like stacking capability for daily use, *Dialog* offers suitable tableware for every occasion. It is not without reason that *Dialog* is one of the most popular collections of the Bauscher brand. **Design: Hans-Wilhelm Seitz, 1991**



THE PORCELAIN OF TOMORROW – SINCE 1881



## A matter of shape

Minimalist, functional hollow-ware like tea and coffee pots, jugs, and sauce boats, easy-grip, practical handles, and generously proportioned plate surfaces allow for ingenious presentation of dishes. These benefits make *Dialog* especially popular with professional chefs.

# Delightful table decorations

Whether patterned or pure white, the softly sweeping contours of the pieces combined with the minimalist relief make *Dialog* the suitable backdrop for the mood-enhancing presentation of dishes from a wide range of culinary concepts.



Décor Nadine (408710)





1 411340 Tina Rot-Gelb  
 2 411350 Tina Blau-Grün



407530 Sonja



412590 Cabo



1 412980 Poppy Blau-Rot  
 2 412990 Poppy Gelb-Grün



424410 Alissa



1 328509 Grafische Linien Rot  
 2 328563 Grafische Linien Blau

| Bezeichnung | Bestell-Nr.   | Inhalt l         | Durchmesser mm  | Höhe 1/11 Stück mm     | Gewicht g |
|-------------|---------------|------------------|-----------------|------------------------|-----------|
| Article     | Order No.     | Volume (fl. oz.) | Diameter (inch) | Height 1/11 pieces     | Weight    |
| Description | Code          | Contenance       | Dimensions      | Hauteur 1/11 pièces    | Poids     |
| Descripción | Nº pedido     | Contenido        | Diámetro        | Altura por 1/11 piezas | Peso      |
| Descrizione | Numero ordine | Contenuto        | Diametro        | Altezza al 1/11 pezzi  | Peso      |



**Kaffeekanne, Coffeepot,**  
Cafetière, Cafetera, Caffettiera

|                              |                |              |            |       |     |
|------------------------------|----------------|--------------|------------|-------|-----|
| > Kaffeekanne komplett 0.30  | <b>80 4130</b> | 0,30 (10.14) | 153 (6.02) | 106/- | 350 |
| > Kaffeekanne Unterteil 0.30 | <b>80 4131</b> | 0,30 (10.14) | 153 (6.02) | 103/- | 300 |
| > Kaffeekanne Deckel 0.30    | <b>80 4132</b> | -            | 60 (2.36)  | 33/-  | 50  |



**Teekanne, Teapot,**  
Théière, Tetera, Teiera

|                           |                |              |            |      |     |
|---------------------------|----------------|--------------|------------|------|-----|
| > Teekanne komplett 0.35  | <b>80 4335</b> | 0,35 (11.83) | 168 (6.61) | 97/- | 420 |
| > Teekanne Unterteil 0.35 | <b>80 4336</b> | 0,35 (11.83) | 168 (6.61) | 95/- | 370 |
| > Teekanne Deckel 0.35    | <b>80 4337</b> | -            | 60 (2.36)  | 33/- | 50  |



**Milchgießer, Creamer,**  
Pot à lait, Lechera, Lattiera

|                                |                |              |            |       |     |
|--------------------------------|----------------|--------------|------------|-------|-----|
| > Milchgießer ohne Henkel 0.04 | <b>80 4604</b> | 0,04 (1.35)  | 62 (2.44)  | 48/-  | 60  |
| > Milchgießer mit Henkel 0.15  | <b>80 4715</b> | 0,15 (5.07)  | 118 (4.65) | 80/-  | 190 |
| > Milchgießer mit Henkel 0.30  | <b>80 4730</b> | 0,32 (10.82) | 152 (5.98) | 100/- | 330 |



**Schale, Dish,**  
Coupelle, Platillo, Coppetta

|            |                |             |           |        |    |
|------------|----------------|-------------|-----------|--------|----|
| > Schale 6 | <b>80 5706</b> | 0,04 (1.35) | 66 (2.60) | 20/190 | 55 |
|------------|----------------|-------------|-----------|--------|----|



**Schale, Dish,**  
Coupelle, Platillo, Coppetta

|            |                |             |           |      |    |
|------------|----------------|-------------|-----------|------|----|
| > Schale 6 | <b>80 4050</b> | 0,04 (1.35) | 66 (2.60) | 28/- | 75 |
|------------|----------------|-------------|-----------|------|----|



**Zucker-/Marmeladendose mit Deckelausschnitt, Sugar/Jam bowl with lid notch,**  
Sucrier/Confiturier couvercle avec encoche, Azucarero, Zuccheriera

|   |                |             |           |      |     |
|---|----------------|-------------|-----------|------|-----|
| > Zucker-/Marmeladendose komplett 0.18  | <b>80 4918</b> | 0,18 (6.09) | 90 (3.54) | 78/- | 220 |
| > Zucker-/Marmeladendose Unterteil 0.18 | <b>80 4919</b> | 0,18 (6.09) | 90 (3.54) | 60/- | 180 |
| > Zucker-/Marmeladendose Deckel 0.18    | <b>80 4920</b> | -           | 62 (2.44) | 29/- | 40  |

| Bezeichnung | Bestell-Nr.   | Inhalt I         | Durchmesser mm  | Höhe 1/11 Stück mm     | Gewicht g |
|-------------|---------------|------------------|-----------------|------------------------|-----------|
| Article     | Order No.     | Volume (fl. oz.) | Diameter (inch) | Height 1/11 pieces     | Weight    |
| Description | Code          | Contenance       | Dimensions      | Hauteur 1/11 pièces    | Poids     |
| Descripción | Nº pedido     | Contenido        | Diámetro        | Altura por 1/11 piezas | Peso      |
| Descrizione | Numero ordine | Contenuto        | Diametro        | Altezza al 1/11 pezzi  | Peso      |

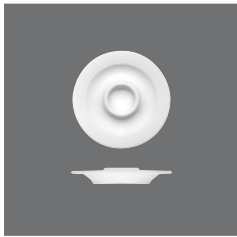

**Eierbecher**, Egg cup,  
Coquetier, Copa de huevo, Portauovo

|              |                |   |            |        |     |
|--------------|----------------|---|------------|--------|-----|
| > Eierbecher | <b>80 4001</b> | - | 131 (5.16) | 21/114 | 145 |
|--------------|----------------|---|------------|--------|-----|



**Tasse stapelbar**, Cup stackable and saucer,  
Tasse empilable et soucoupe, Taza apilable y platito, Tazza impilabile e piattino

|                            |                |             |            |        |     |
|----------------------------|----------------|-------------|------------|--------|-----|
| > Obertasse 0.09 stapelbar | <b>80 5209</b> | 0,09 (3.04) | 63 (2.48)  | 53/440 | 130 |
| > Untertasse rund 09       | <b>80 6909</b> | -           | 130 (5.12) | 19/102 | 135 |



**Tasse stapelbar**, Cup stackable and saucer,  
Tasse empilable et soucoupe, Taza apilable y platito, Tazza impilabile e piattino

|                            |                |             |            |        |     |
|----------------------------|----------------|-------------|------------|--------|-----|
| > Obertasse 0.18 stapelbar | <b>80 5118</b> | 0,18 (6.09) | 77 (3.03)  | 58/498 | 160 |
| > Kombi-Untertasse         | <b>80 6918</b> | -           | 160 (6.30) | 20/110 | 215 |
| > Obertasse 0.22 stapelbar | <b>80 5122</b> | 0,22 (7.44) | 78 (3.07)  | 69/628 | 190 |
| > Kombi-Untertasse         | <b>80 6918</b> | -           | 160 (6.30) | 20/110 | 215 |
| > Obertasse 0.27 stapelbar | <b>80 5127</b> | 0,27 (9.13) | 88 (3.46)  | 65/560 | 220 |
| > Kombi-Untertasse         | <b>80 6918</b> | -           | 160 (6.30) | 20/110 | 215 |



**Becher stapelbar**, Mug stackable and saucer,  
Gobelet empilable et soucoupe, Taza mug apilable y platito, Mug impilabile e piattino

|                         |                |             |            |        |     |
|-------------------------|----------------|-------------|------------|--------|-----|
| > Becher 0.26 stapelbar | <b>80 5526</b> | 0,26 (8.79) | 77 (3.03)  | 85/750 | 220 |
| > Kombi-Untertasse      | <b>80 6918</b> | -           | 160 (6.30) | 20/110 | 215 |



**Suppentasse stapelbar**, Cream soup cup stackable and saucer,  
Tasse à consommé empilable et soucoupe, Taza consomé apilable y platito, Tazza brodo impilabile e piattino

|                              |                |             |            |        |     |
|------------------------------|----------------|-------------|------------|--------|-----|
| > Suppentasse 0.28 stapelbar | <b>80 2727</b> | 0,28 (9.47) | 99 (3.90)  | 54/441 | 225 |
| > Kombi-Untertasse           | <b>80 6918</b> | -           | 160 (6.30) | 20/110 | 215 |



**Teller flach Fahne**, Plate flat with rim,  
Assiette plate avec aile, Plato llano con ala, Piatto piano con falda

|                         |                |   |             |        |      |
|-------------------------|----------------|---|-------------|--------|------|
| > Teller flach Fahne 16 | <b>80 0016</b> | - | 160 (6.30)  | 18/102 | 203  |
| > Teller flach Fahne 20 | <b>80 0020</b> | - | 201 (7.91)  | 20/102 | 390  |
| > Teller flach Fahne 23 | <b>80 0023</b> | - | 234 (9.21)  | 23/114 | 505  |
| > Teller flach Fahne 25 | <b>80 0025</b> | - | 257 (10.12) | 25/128 | 630  |
| > Teller flach Fahne 28 | <b>80 0028</b> | - | 276 (10.87) | 29/141 | 800  |
| > Teller flach Fahne 31 | <b>80 0031</b> | - | 310 (12.20) | 25/135 | 1090 |

| Bezeichnung | Bestell-Nr.   | Inhalt I         | Durchmesser mm  | Höhe 1/11 Stück mm     | Gewicht g |
|-------------|---------------|------------------|-----------------|------------------------|-----------|
| Article     | Order No.     | Volume (fl. oz.) | Diameter (inch) | Height 1/11 pieces     | Weight    |
| Description | Code          | Contenance       | Dimensions      | Hauteur 1/11 pièces    | Poids     |
| Descripción | Nº pedido     | Contenido        | Diámetro        | Altura por 1/11 piezas | Peso      |
| Descrizione | Numero ordine | Contenuto        | Diametro        | Altezza al 1/11 pezzi  | Peso      |

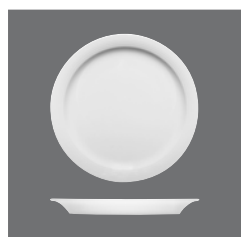

**Teller flach schmale Fahne**, Plate flat with narrow rim,  
Assiette plate avec aile étroite, Plato llano con ala estrecha, Piatto piano con falda stretta

|                                 |                |   |             |        |     |
|---------------------------------|----------------|---|-------------|--------|-----|
| > Teller flach schmale Fahne 25 | <b>80 0625</b> | - | 257 (10.12) | 26/147 | 775 |
|---------------------------------|----------------|---|-------------|--------|-----|



**Teller halbtief Fahne**, Plate half-deep with rim,  
Assiette demi-creuse avec aile, Plato medio hondo con ala, Piatto semifondo con falda

|                            |                |             |            |        |     |
|----------------------------|----------------|-------------|------------|--------|-----|
| > Teller halbtief Fahne 20 | <b>80 0220</b> | 0,23 (7.78) | 200 (7.87) | 26/115 | 365 |
|----------------------------|----------------|-------------|------------|--------|-----|



**Teller tief Fahne**, Plate deep with rim,  
Assiette creuse avec aile, Plato hondo con ala, Piatto fondo con falda

|                        |                |              |            |        |     |
|------------------------|----------------|--------------|------------|--------|-----|
| > Teller tief Fahne 23 | <b>80 0123</b> | 0,36 (12.17) | 234 (9.21) | 36/137 | 480 |
|------------------------|----------------|--------------|------------|--------|-----|



**Platte oval Fahne**, Platter oval with rim,  
Plat ovale avec aile, Fuente oval con ala, Piatto ovale

|                        |                |   |                       |        |      |
|------------------------|----------------|---|-----------------------|--------|------|
| > Platte oval Fahne 26 | <b>80 2026</b> | - | 260x179 (10.24x 7.05) | 24/110 | 430  |
| > Platte oval Fahne 32 | <b>80 2032</b> | - | 320x240 (12.60x 9.45) | 24/148 | 870  |
| > Platte oval Fahne 35 | <b>80 2035</b> | - | 350x270 (13.78x10.63) | 28/151 | 1000 |



**Salatiere rund**, Salad dish round,  
Saladier rond, Ensaladera redonda, Insalatiera rotonda

|                     |                |              |            |        |     |
|---------------------|----------------|--------------|------------|--------|-----|
| > Salatiere rund 16 | <b>80 3166</b> | 0,32 (10.82) | 158 (6.22) | 45/140 | 250 |
| > Salatiere rund 18 | <b>80 3168</b> | 0,48 (16.23) | 187 (7.36) | 50/150 | 370 |
| > Salatiere rund 22 | <b>80 3172</b> | 0,78 (26.37) | 222 (8.74) | 58/160 | 530 |



**Kompottschale rund**, Fruit saucer round,  
Compotier rond, Compotera redonda, Coppetta rotonda

|                    |                |             |            |        |     |
|--------------------|----------------|-------------|------------|--------|-----|
| > Kompottschale 14 | <b>80 3064</b> | 0,22 (7.44) | 144 (5.67) | 38/130 | 190 |
|--------------------|----------------|-------------|------------|--------|-----|

| Bezeichnung | Bestell-Nr.   | Inhalt I         | Durchmesser mm  | Höhe 1/11 Stück mm     | Gewicht g |
|-------------|---------------|------------------|-----------------|------------------------|-----------|
| Article     | Order No.     | Volume (fl. oz.) | Diameter (inch) | Height 1/11 pieces     | Weight    |
| Description | Code          | Contenance       | Dimensions      | Hauteur 1/11 pièces    | Poids     |
| Descripción | Nº pedido     | Contenido        | Diámetro        | Altura por 1/11 piezas | Peso      |
| Descrizione | Numero ordine | Contenuto        | Diametro        | Altezza al 1/11 pezzi  | Peso      |



**Schale rund**, Fruit saucer round,  
Compotier rond, Compotera redonda, Coppetta rotonda

|                  |                |             |            |        |     |
|------------------|----------------|-------------|------------|--------|-----|
| > Schale rund 12 | <b>80 3012</b> | 0,28 (9.47) | 122 (4.80) | 39/260 | 245 |
|------------------|----------------|-------------|------------|--------|-----|



**Suppenschale**, Soup bowl,  
Bol à soup, Bowl sopa, Coppetta zuppa

|                    |                |              |            |        |     |
|--------------------|----------------|--------------|------------|--------|-----|
| > Suppenschale 12  | <b>80 6512</b> | 0,38 (12.85) | 120 (4.72) | 52/380 | 300 |
| > Eintopfschale 17 | <b>80 6517</b> | 0,94 (31.78) | 168 (6.61) | 63/430 | 560 |

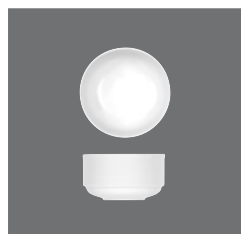

**Bowl rund**, Bowl round,  
Bol rond, Bowl redondo, Bowl rotondo

|                  |                |             |           |        |     |
|------------------|----------------|-------------|-----------|--------|-----|
| > Bowl rund 0.28 | <b>80 6510</b> | 0,28 (9.47) | 99 (3.90) | 55/441 | 205 |
|------------------|----------------|-------------|-----------|--------|-----|



**Saucenschälchen**, Sauce-boat small,  
Saucière petite, Salsera pequeña, Salsiera piccola

|                        |                |             |            |      |     |
|------------------------|----------------|-------------|------------|------|-----|
| > Saucenschälchen 0.10 | <b>80 3810</b> | 0,10 (3.38) | 109 (4.29) | 60/- | 130 |
|------------------------|----------------|-------------|------------|------|-----|



**Sauciere**, Sauce-boat,  
Saucière, Salsera, Salsiera

|                 |                |              |            |      |     |
|-----------------|----------------|--------------|------------|------|-----|
| > Sauciere 0.30 | <b>80 3830</b> | 0,30 (10.14) | 153 (6.02) | 78/- | 270 |
|-----------------|----------------|--------------|------------|------|-----|

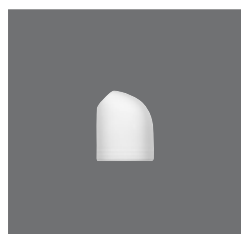

**Salz- / Pfefferstreuer**, Salt / Pepper shaker,  
Salière / Poivrière, Salero / Pimentero, Spargi sale / Spargi pepe

|                  |                |   |           |      |    |
|------------------|----------------|---|-----------|------|----|
| > Salzstreuer    | <b>80 4010</b> | - | 55 (2.17) | 66/- | 70 |
| > Pfefferstreuer | <b>80 4020</b> | - | 51 (2.01) | 57/- | 50 |



| Bezeichnung | Bestell-Nr.   | Inhalt I         | Durchmesser mm  | Höhe 1/11 Stück mm     | Gewicht g |
|-------------|---------------|------------------|-----------------|------------------------|-----------|
| Article     | Order No.     | Volume (fl. oz.) | Diameter (inch) | Height 1/11 pieces     | Weight    |
| Description | Code          | Contenance       | Dimensions      | Hauteur 1/11 pièces    | Poids     |
| Descripción | Nº pedido     | Contenido        | Diámetro        | Altura por 1/11 piezas | Peso      |
| Descrizione | Numero ordine | Contenuto        | Diametro        | Altezza al 1/11 pezzi  | Peso      |



**Tischvase**, Flower vase,  
Vase à fleurs, Florero, Vaso per fiori

> Tischvase

**80 8100**

-

77 (3.03)

107/-

165



**Ascher**, Ashtray,  
Cendrier, Cenicero, Posacenere

> Ascher

**80 7500**

-

90 (3.54)

33/327

150



**Leuchter Tülle 18 DIN 7409**, Candleholder,  
Bougeoir, Candelabro, Portacandela

> Leuchter

**80 7700**

-

80 (3.15)

38/-

100



SHAPED BY  
RESPONSIBILITY

ISO 14001 + ISO 50001 CERTIFIED

## Imprint

Published by

BAUSCHER

Obere Bauscherstraße 1 · 92637 Weiden · Germany

T +49(0)961 82-0 · F +49(0)961 82-31 02 | -31 14 (international)

E [info@bauscher.de](mailto:info@bauscher.de) | [www.bauscher.com](http://www.bauscher.com)

MADE IN  
GERMANY

